

# FORTE PRO

The Professional Hair Dryer



FP 2020H  
USER'S MANUAL



## IMPORTANT SAFETY INSTRUCTIONS

Before using this appliance, please read all instructions and cautionary in this manual.

### WARNING

1. Do not stretch the cable, place the cable under strain or unplug by pulling on the cable. The use of an extension cable is not recommended. If the cable is damaged, it must be replaced or repaired by the manufacturer, its service agent or similarly qualified persons in order to avoid a hazard.
2. Keep the cable away from heated surfaces and do not wrap the cable around this appliance.
3. Unplug the appliance from the power outlet when it is not in use. Do not handle any part of the plug or appliance with wet hands.
4. Do not use this appliance near bathtubs, showers, basins or other vessels containing water. Do not use the appliance with wet hands, in a damp environment or on wet surfaces.
5. Do not immerse the appliance in water or other liquids.
6. If the appliance is not working as it should, if it has been dropped, damaged, left outdoors, or dropped into water, please do not use.
7. Do not disassemble the appliance as incorrect reassembly may result in an electric shock or fire.
8. When the appliance is used in a bathroom, unplug it after use since the proximity of water presents a hazard even when the appliance is turned off. For additional protection, it is recommended that a Residual Current Device (RCD), with a residual operating current not exceeding 30 mA is installed in the electrical circuit supplying the bathroom.
9. This appliance cannot be used by children. It can be used by persons with reduced physical, sensory or reasoning capabilities, or lack of experience and knowledge only if they have been given supervision or instruction by a responsible person concerning use of the appliance in a safe way and understand the hazards involved.
10. To clean the appliance surface, unplug the appliance. Do not use aggressive products containing phenyl phenol.
11. Do not use the appliance for any other purpose than drying hair.

## Overview

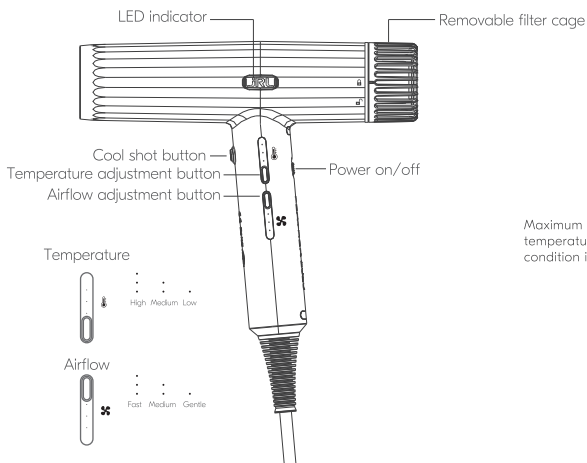

Maximum operating temperature in normal working condition is up to 125°C.

JRL FORTE PRO professional blow dryer



Styling concentrator



Smoothing nozzle

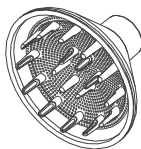

Diffuser



Cleaning brush

## Product specifications

MODEL	SPECIFICATION		
FP 2020H	220-240V~	50/60Hz	1900-2150W
	120-125V~	60Hz	1800-1875W

## Instructions

Make sure that your hands are dry before connecting the appliance to the mains.

Connect the appliance and push the power switch from "0" to "I" (Fig.1).

When switched on for the first time, the appliance will blow air at the lowest temperature and gentle airflow. The first LED of the side buttons will light up.

### Memory function

This allows the appliance to memorize the selected speed and the temperature previous use.

### Cleaning warning

When the JRL led indicator light is red, you will need to clean the filter cage.

### Autocleaning function and warning

This function is to clean the inner components of blow dryer. It is recommended to use once or twice a month.

Turn the appliance off, hold the handle of your appliance firmly and carefully rotate the filter cage anti-clockwise. Pull it down and away from the appliance. Then press the airflow adjustment button and hold for 5 seconds (Fig.2).

This will rotate the motor turbine in the opposite direction for 15 seconds, allowing deep cleaning of the filter by expelling any particles left on the filter. When the autocleaning is done, put the filter cage back into position, rotate clockwise to lock before use.

If you want to stop the autocleaning, turn on the appliance, the appliance will function normally.

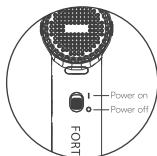

Fig.1

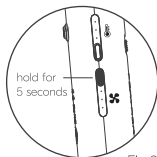

Fig.2

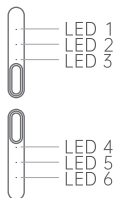
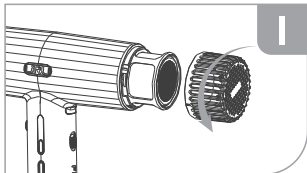

Fig.3

## Cleaning and maintenance

To ensure the best performance and to extend product life, we advise you to clean the filter cage every day, at least once a day. Unplug your appliance from the main electricity supply before cleaning your filter.



**Step 1.** Hold the handle of your appliance firmly and rotate the filter cage anti-clockwise. Pull down and away from the appliance.

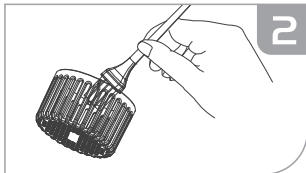

**Step 2.** Use the cleaning brush to remove any dust or debris from the filter cage.

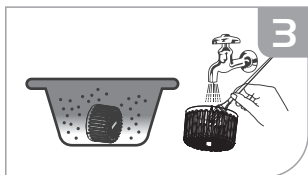

**Step 3.** The following step is only needed every 15 days. Immerse the filter cage in soap water for 30 minutes, and use the cleaning brush to remove any dust or debris. Rinse and dry the filter cage.

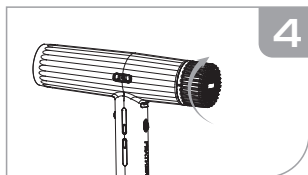

**Step 4.** Rotate the filter cage back into position, ensuring it is locked before use.

## Diagnostics

Error mode	LED1	LED2	LED3	LED4	LED5	LED6
Hardware protection against overcurrent	blink	off	off	off	off	off
NTC abnormality	off	blink	off	off	off	off
Software protection against overcurrent	blink	blink	off	off	off	off
Bus overvoltage	blink	blink	blink	off	off	off
Bus undervoltage	blink	blink	blink	blink	off	off
Motor jammed	blink	blink	blink	blink	blink	off
Defective phase	blink	blink	blink	blink	blink	blink
Others	blink	off	blink	off	blink	off

## Warranty

1. Under normal conditions of proper use and maintenance of the product, the warranty period of the product is 1 year.
2. Expendable parts, such as filter cage, cleaning brushes, etc., are not under the terms of the warranty.
3. The following conditions are not covered by the warranty service:
  - \* Failure to show a valid receipt/proof which is inconsistent with the actual product.  
Receipt/proof must be included.
  - \* Appliances with alterations will not be covered by the warranty service.
  - \* Failure to follow the instructions in the instruction manual to operate and maintain the appliance, causing it to malfunction or damage by dropping the appliance, immersing the appliance in water and physical alterations of any kind will void the warranty service.
  - \* Product damage due to transportation or improper storage.
  - \* Use of the machine for anything other than as a hair dryer.
4. The company will charge a maintenance fee for products without a receipt/proof or beyond the warranty period.
5. Please send the appliance in need of repair or warranty directly to Bratt Trading AB for repair, maintenance, or replacement.



**Guang Zhou Eagle  
Fortress Hair Products Ltd.**

No.4 Shuanglong Yucai  
Street, Shiling Town, Huadu  
District, Guangzhou, 510899,  
China

**Bratt Trading AB**

Radiovägen 34  
135 48 Tyresö SWEDEN  
+46 (8) 712 95 10  
info@bratt-trading.se  
www.bratt-trading.com



[www.jrl.com](http://www.jrl.com)



[www.bratt-trading.com](http://www.bratt-trading.com)

